



## Spare parts guide

### ½" to 2" and 2½" to 4"

### 25- and 26-Series main valves

#### ½" to 2" (DN15 to DN50) 25- and 26-Series main valves

Cap assembly with cap screws and gasket	A, B, C
Diaphragm case bolts and nuts	G, H
Screen, spring support disc, valve spring and cap gasket	M, N, O, C
Cap gasket, valve head, seat and seat gasket (specify regular or reduced port "S" valve)	C, P, Q, R
Valve stem guide and gasket	J, S, T

Diaphragm (2 per set)	L
Transmission tubing with fittings	U, V
Gasket kit	C, R, S, W
Diaphragm plate	K
Rebuild kit	B, C, L, M, O, P, Q, R, U, V, W

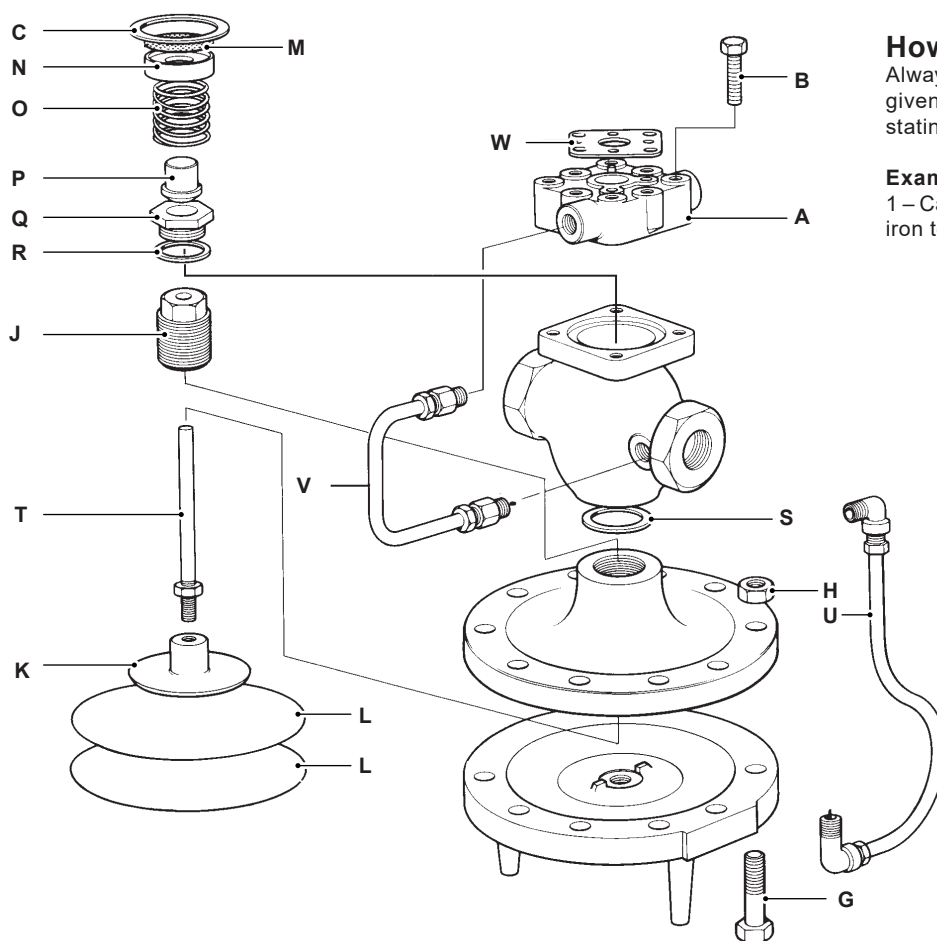

#### How to order

Always order spares by using the description given in the column headed Spare Parts, stating the valve size and material.

#### Example:

1 – Cap assembly for ½" Spirax Sarco 25T cast iron temperature regulator.

#### Maintenance

For complete installation and maintenance instructions, see the IMI sheet, which accompanies the product.

## 2½" to 4" 25- and 26-Series main valves

Cap assembly with cap screws and gasket	<b>A, B, C</b>
Diaphragm case bolts and nuts	<b>G, H</b>
Screen, retaining ring, main valve spring and cap gasket cap	<b>M, N, O, C</b>
Gasket, valve head and seat (specify regular or reduced port "S" valve)	<b>C, P, Q, X</b>
Lower stem and guide	<b>J, S, T</b>

Diaphragms (2 per set)	<b>L</b>
Transmission tubing with assembly	<b>U</b>
Gasket kit	<b>C, S, W</b>
Damping assembly	<b>A1, B1, C1</b>
Diaphragm plate	<b>K</b>
Rebuild kit	<b>B, C, L, M, N, O, P, Q, U, W</b>
Relief tube	<b>D1</b>

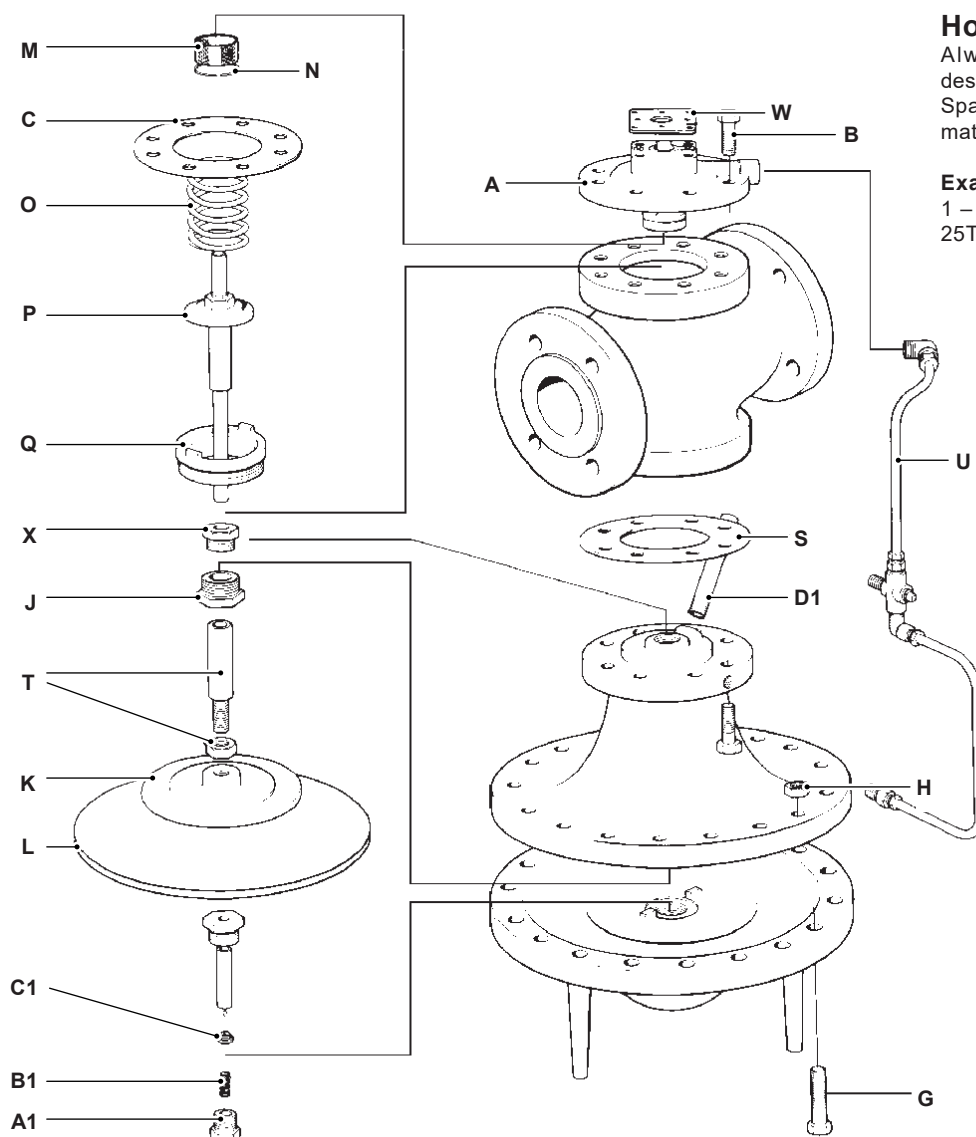

### How to order

Always order spares by using the description given in the first column under Spare Parts, stating the valve size and material.

### Example:

1 – Cap assembly for 2½" Spirax Sarco 25T cast iron temperature regulator

### Maintenance

For complete installation and maintenance instructions, see the IMI sheet, which accompanies the product.